

**位置圖**  
LOCATION PLAN  
不按比例  
NOT TO SCALE

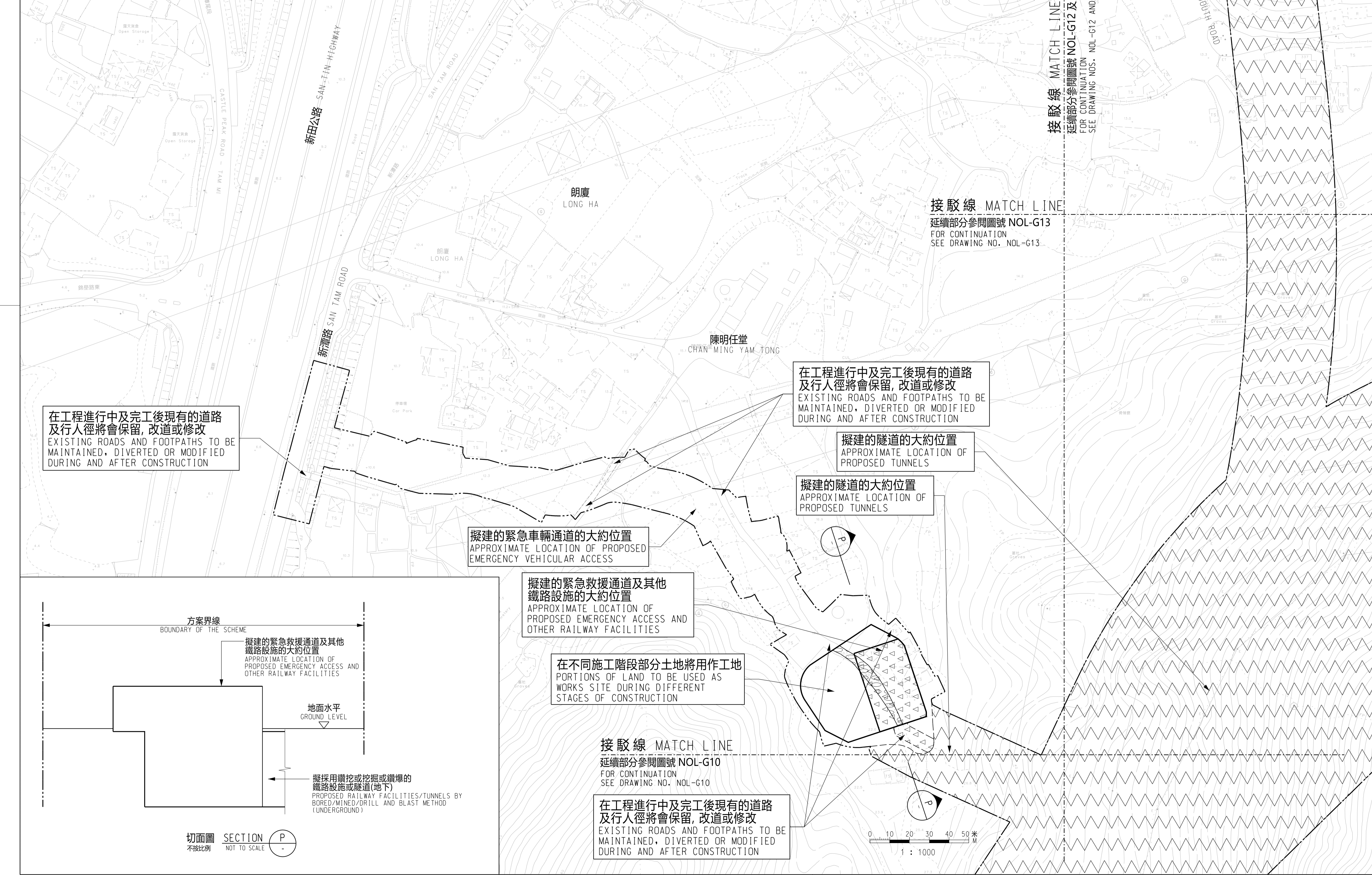

在工程進行中及完工後現有的道路及行人徑將會保留，改道或修改  
EXISTING ROADS AND FOOTPATHS TO BE MAINTAINED, DIVERTED OR MODIFIED DURING AND AFTER CONSTRUCTION

在工程進行中及完工後現有的道路及行人徑將會保留，改道或修改  
EXISTING ROADS AND FOOTPATHS TO BE MAINTAINED, DIVERTED OR MODIFIED DURING AND AFTER CONSTRUCTION

擬建的隧道的大約位置  
APPROXIMATE LOCATION OF PROPOSED TUNNELS

擬建的隧道的大約位置  
APPROXIMATE LOCATION OF PROPOSED TUNNELS

擬建的緊急車輛通道的大約位置  
APPROXIMATE LOCATION OF PROPOSED EMERGENCY VEHICULAR ACCESS

擬建的緊急救援通道及其他鐵路設施的大約位置  
APPROXIMATE LOCATION OF PROPOSED EMERGENCY ACCESS AND OTHER RAILWAY FACILITIES

在不同施工階段部分土地將用作工地  
PORTIONS OF LAND TO BE USED AS WORKS SITE DURING DIFFERENT STAGES OF CONSTRUCTION

接駁線 MATCH LINE  
延續部分參閱圖號 NOL-G10  
FOR CONTINUATION  
SEE DRAWING NO. NOL-G10

在工程進行中及完工後現有的道路及行人徑將會保留，改道或修改  
EXISTING ROADS AND FOOTPATHS TO BE MAINTAINED, DIVERTED OR MODIFIED DURING AND AFTER CONSTRUCTION

接駁線 MATCH LINE  
延續部分參閱圖號 NOL-G12 及 G13  
FOR CONTINUATION  
SEE DRAWING NOS. NOL-G12 AND G13

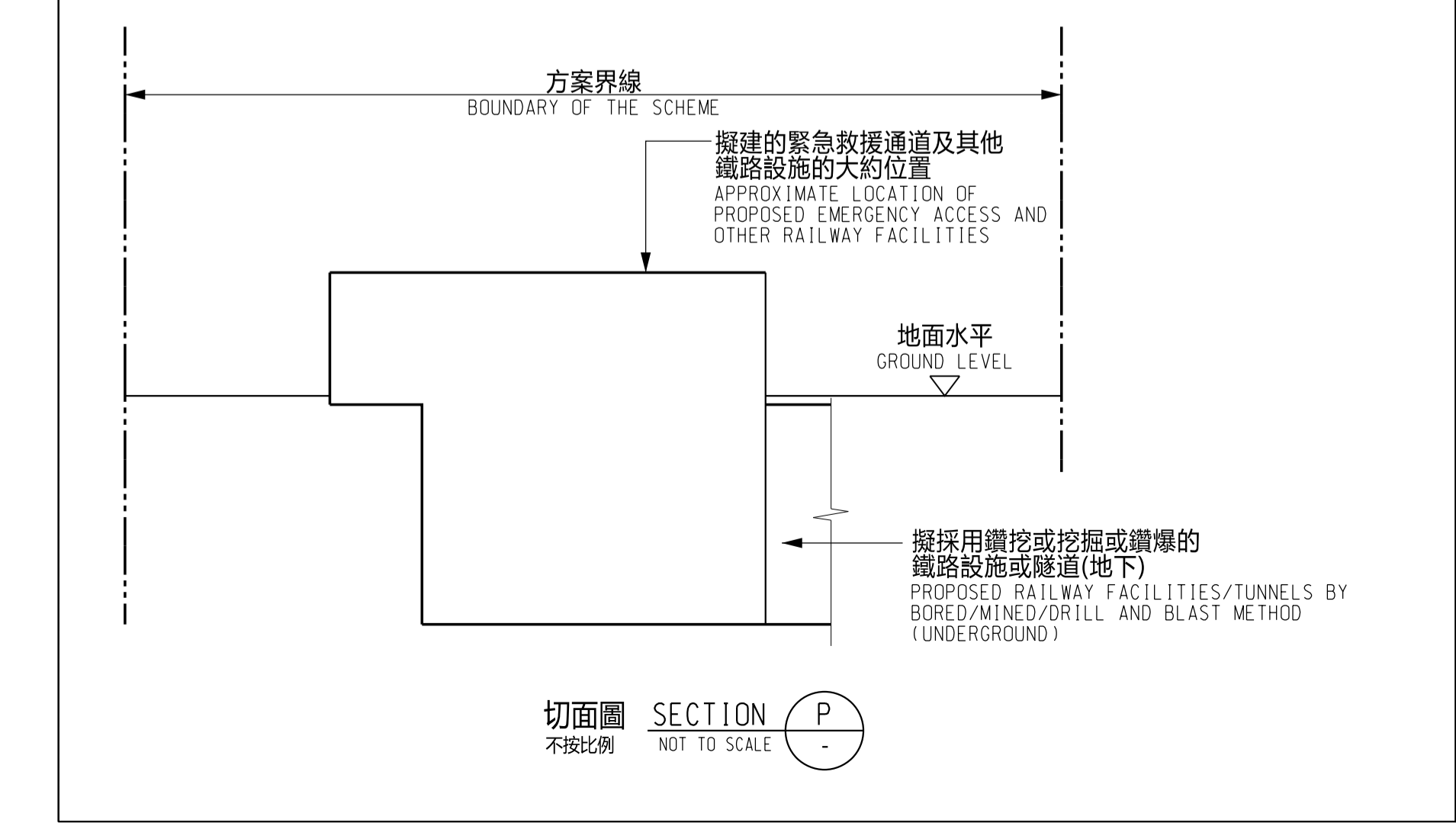

**剖面圖**  
SECTION P  
不按比例  
NOT TO SCALE

**圖例** LEGEND :

- 方案界線  
BOUNDARY OF THE SCHEME
- 擬建的鐵路車站及其他鐵路設施(地下)  
PROPOSED RAILWAY STATION AND OTHER RAILWAY FACILITIES (UNDERGROUND)
- 擬建的車站/車站入口/通風大樓/通風井/其他鐵路設施或永久建築物  
PROPOSED RAILWAY STATION/ STATION ENTRANCES/ VENTILATION BUILDINGS/ VENTILATION SHAFTS/ OTHER RAILWAY FACILITIES OR PERMANENT STRUCTURES
- 現有的車站及其他鐵路設施  
EXISTING STATION AND OTHER RAILWAY FACILITIES
- 擬採用鑽挖或挖掘或鑽爆的鐵路設施或隧道(地下)  
PROPOSED RAILWAY FACILITIES/ TUNNELS BY BORED/ MINED/ DRILL AND BLAST METHOD (UNDERGROUND)
- 擬採用明挖回填法興建的鐵路設施或隧道(地下)  
PROPOSED RAILWAY FACILITIES/ TUNNELS BY CUT-AND-COVER METHOD (UNDERGROUND)
- 可能永久封閉的道路(包括行人道、行人徑及露天地方)  
ROADS (INCLUDING CARRIAGEWAYS, FOOTPATHS AND OPEN PLACE) WHICH MAY BE CLOSED PERMANENTLY
- 擬設置地盤設施的臨時施工區  
PROPOSED TEMPORARY WORKS AREA FOR SITE FACILITIES
- 擬進行修改工程的現有的鐵路車站及設施  
PROPOSED MODIFICATION WORKS OF THE EXISTING RAILWAY STATIONS AND FACILITIES
- 擬建供北環線主線及其他正在規劃的鐵路項目(下稱「其他鐵路項目」)使用的隧道(地下)/車站/車站大樓/車站入口/通風大樓/通風井/其他鐵路設施或永久建築物(下稱「設施」)。設施的布局已刊載於其他鐵路項目方案內  
PROPOSED RAILWAY TUNNEL (UNDERGROUND)/ RAILWAY STATION/ STATION CONCOURSE/ STATION ENTRANCES/ OTHER RAILWAY FACILITIES OR PERMANENT STRUCTURES (HEREAFTER REFERRED TO AS "THE FACILITIES") FOR NORTHERN LINK MAIN LINE AND ANOTHER RAILWAY PROJECT UNDER PLANNING (HEREAFTER REFERRED TO AS "ANOTHER RAILWAY PROJECT"). THE LAYOUT OF THE FACILITIES IS GAZETTED UNDER ANOTHER RAILWAY PROJECT

**一般說明** GENERAL NOTES :

- 有關一般說明參閱圖號 NOL-G01.  
FOR GENERAL NOTES, REFER TO DRAWING NO. NOL-G01.

修訂表  
TABLE OF AMENDMENTS

修改 REV	日期 DATE	繪圖 BY	核對 SUB	負責 APP	說明 DESCRIPTION

**SIGNED**  
林雨舟 LAM YU CHAU  
獲准發出  
APPROVED FOR ISSUE  
路政署  
鐵路拓展處處長(1)  
GOVERNMENT ENGINEER/  
RAILWAY DEVELOPMENT (1)  
HIGHWAYS DEPARTMENT  
19 SEP 2023  
發出日期 DATE OF ISSUE

圖則名稱 DRAWING TITLE  
**鐵路條例(第519章)  
北環線主線  
總體規劃圖則**  
29頁的第11頁  
RAILWAYS ORDINANCE (CHAPTER 519)  
NORTHERN LINK MAIN LINE  
GENERAL LAYOUT PLAN SHEET 11 OF 29

圖號 DRAWING NO.  
NOL-G11  
比例 SCALE  
1:1000 (A1)  
或如圖示  
AS SHOWN